



SRI SERIES

Frameless motor with high torque density, Lower cogging torque, smooth running. Always use for robot arm, medical equipment and other high precision industry.

Motor Parameters/Dimensions	SRI 50	SRI 60	SRI 70	SRI 80	SRI 100
Weight (g)	200	165	275	470	550
Voltage (V)	48	48	48	48	48
Rated Torque (Nm)	0.58	0.58	0.94	1.45	1.75
Peak Torque (Nm)	1.63	1.64	2.63	4	4.92
Max Speed@Rated Torque (rpm)	4000	3900	3200	3200	3100
Rated Current (A)	5	6.3	7.9	10	15.5
Peak Current (A)	14	18	22	28	43
Kv (rpm/V)	92	115	90	73	95
Kt (Nm/A)	0.104	0.083	0.106	0.1308	0.1005
Ke (V/rpm)	0.0109	0.0087	0.0111	0.0137	0.0106
Km (Nm/ \sqrt{w})	0.1658	0.1088	0.1807	0.4313	0.3368
Pole-pairs	7	14	14	7	14
Phase to Phase resistance (m Ω)	1175	585	350	92	98
Phase to Phase Inductance (μ H)	740	375	314	155	228
Max Torque Weight Ratio (N.m/kg)	8.15	10	9.5	8.5	9

Dimensions	SRI 50	SRI 60	SRI 70	SRI 80	SRI 100
Stator OD A +0.05[mm]	54	60	76	85	104
Rotor ID B +0.02[mm]	22	30	38	40.5	45
Rotor OD C [mm]	28.6	35.8	45.8	50	55.6
Stator ID D [mm]	29.6	37	47	51	57
Winding ID E [mm]	30.6	38	48	52	58
Winding OD F + 1 [mm]	53	58	73	84	101
Lamination Height G +0.4/-0.2 [mm]	16	13	13	16	13
Winding height H [mm] Wire exit side	5	5	5.5	6	7
Winding height I [mm]	3	3	3.5	4	4.5

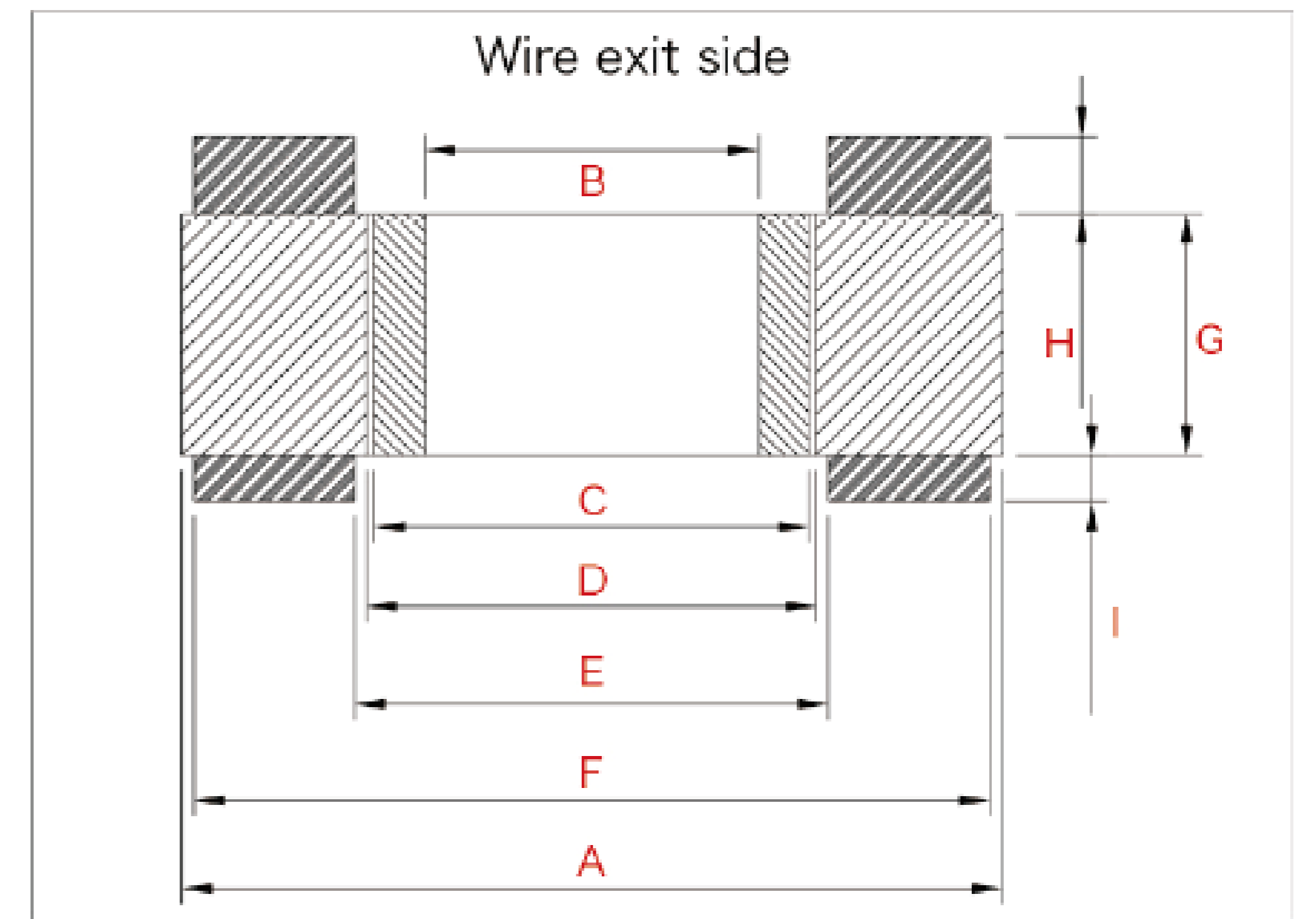

SRI50 motor speed vs torque: 48V

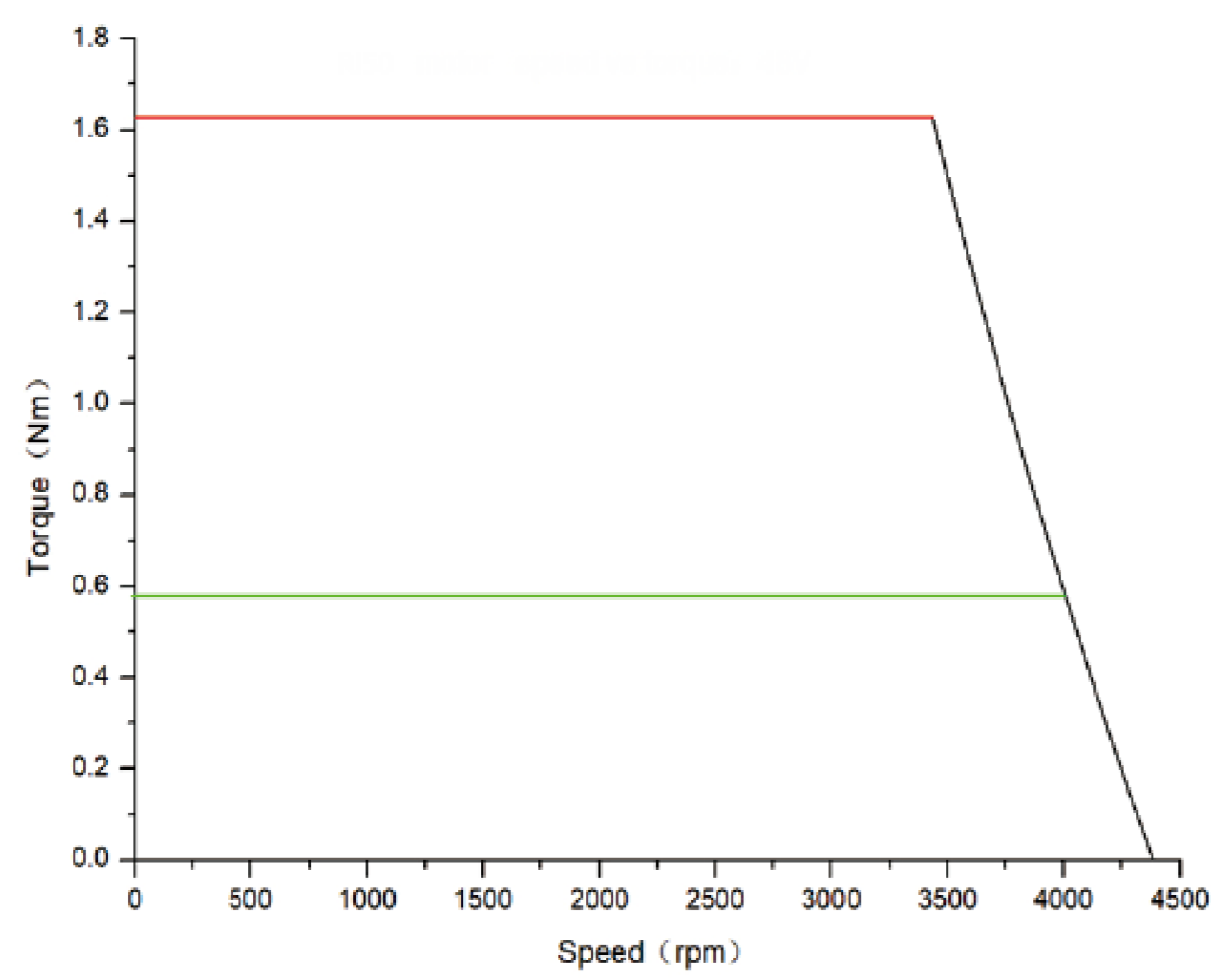

SRI60 motor speed vs torque: 48V

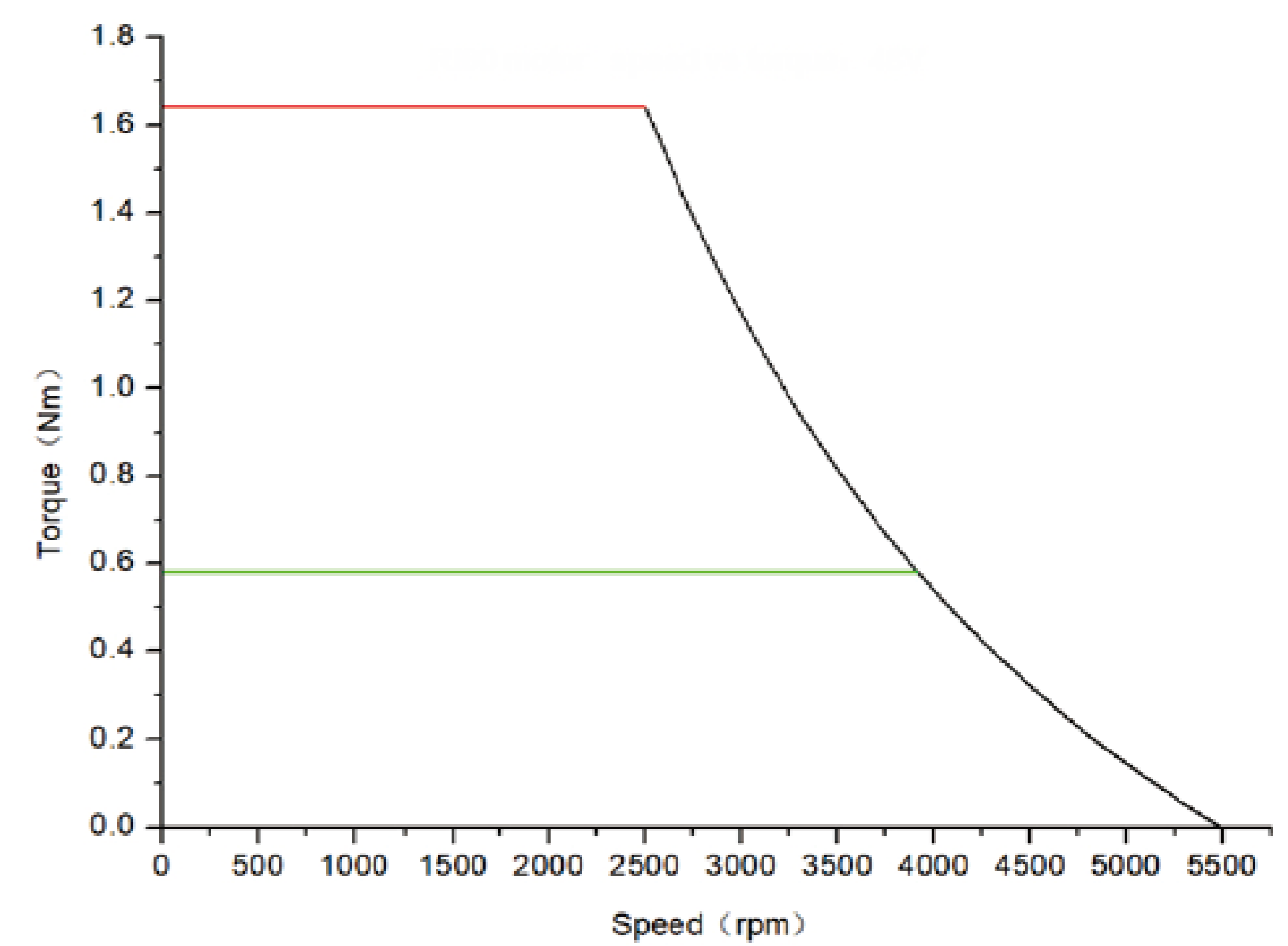

SRI70 motor speed vs torque: 48V

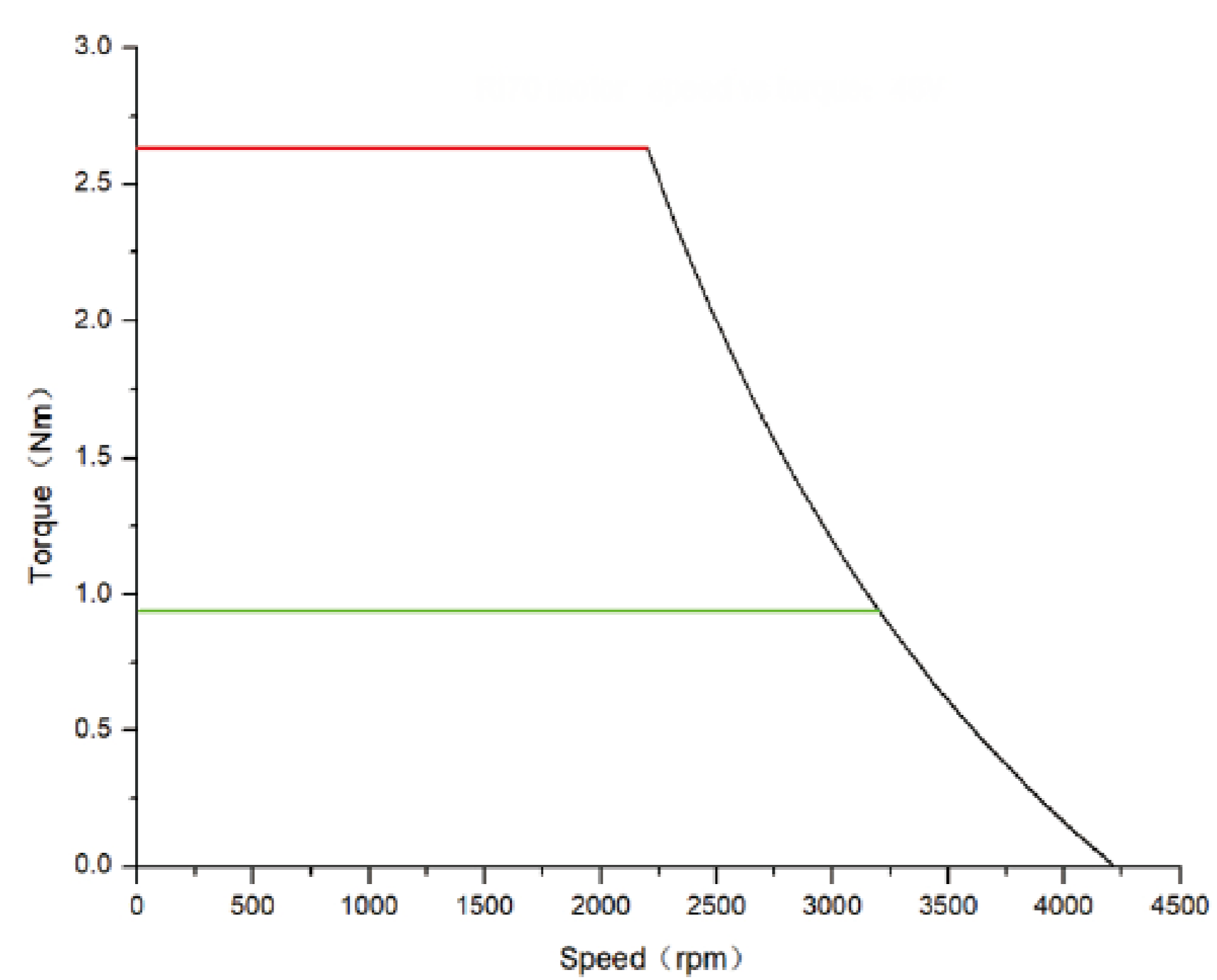

SRI80 motor speed vs torque: 48V

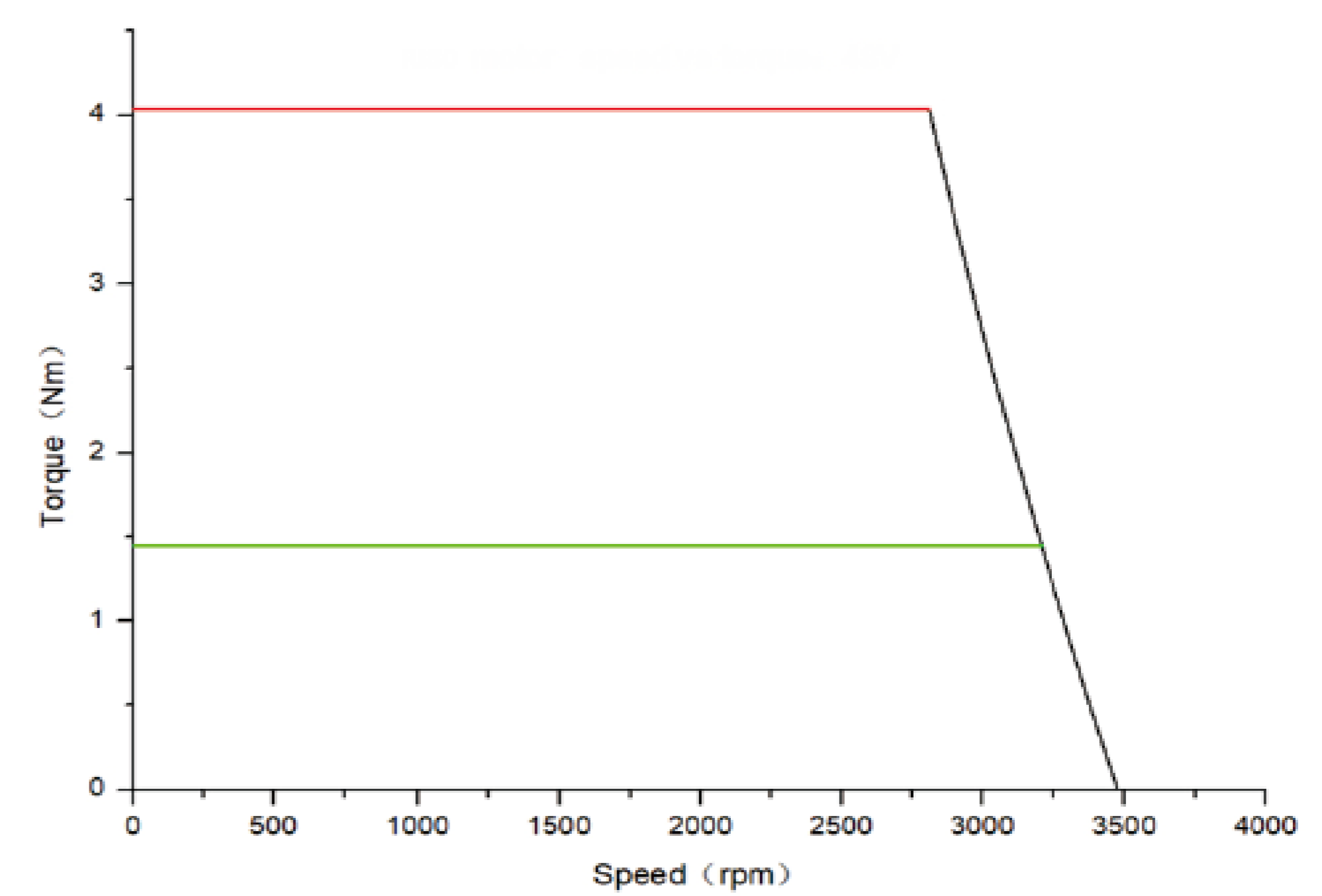

SRI100 motor speed vs torque: 48V

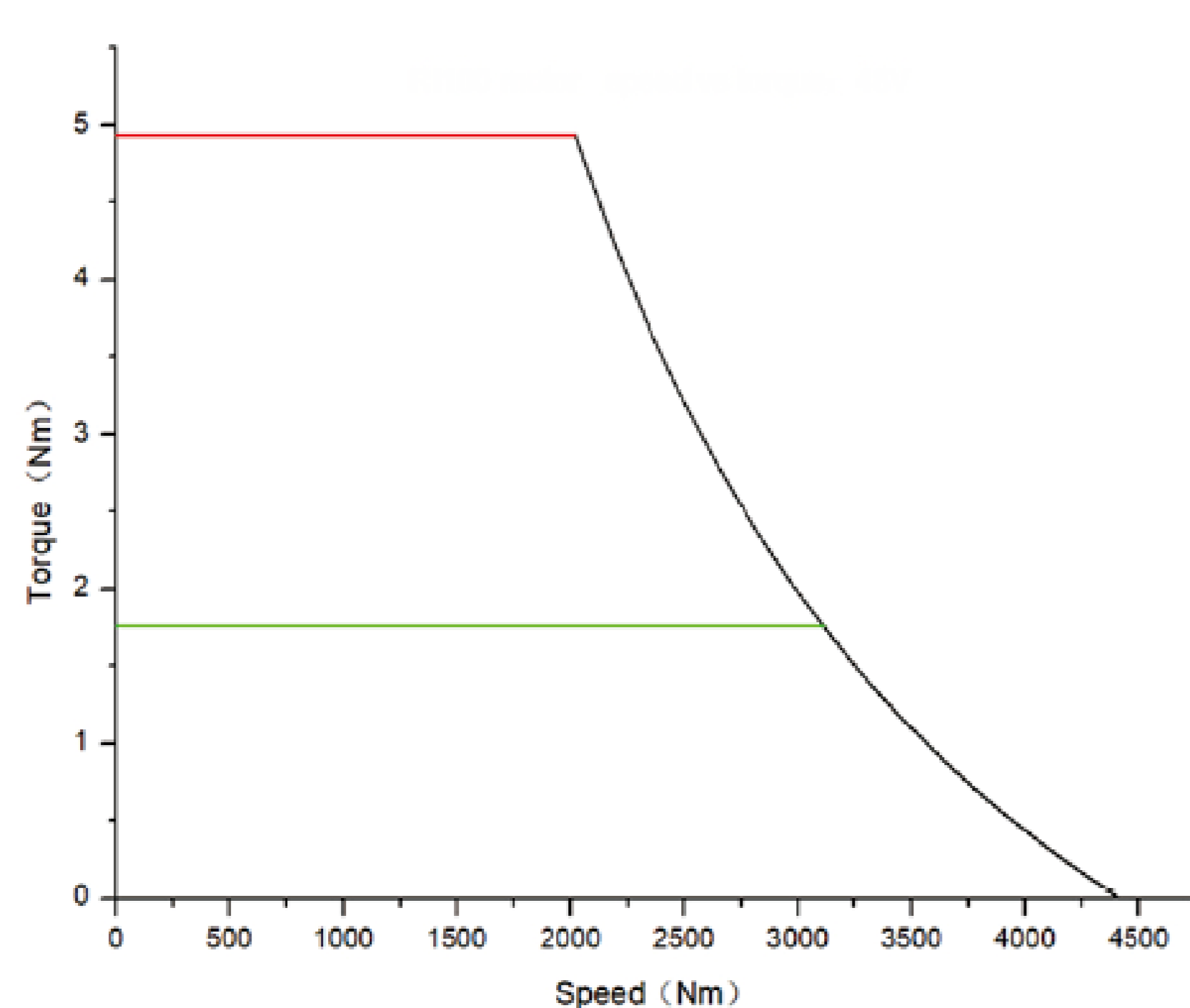

SRI Series Performance Curve

█ Rated Torque (Nm)

█ Peak Torque (Nm)